

## DISASSEMBLY

### 1. REMOVE GENERATOR PULLEY

SST 09820-63011

- (a) Hold SST (A) with a torque wrench, and tighten SST (B) clockwise with the specified torque.

**Torque: 39 N·m (400 kgf·cm, 29 ft·lbf)**

#### NOTICE:

**Check that SST is secured to the rotor shaft.**

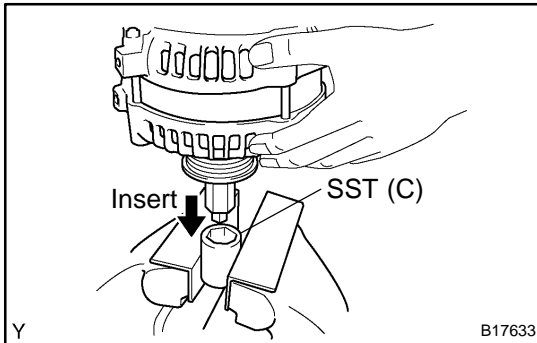

- (b) Mount SST 2 in a vise.

- (c) Insert SST (A) and (B) into SST (C), and attach the pulley nut to SST (C).

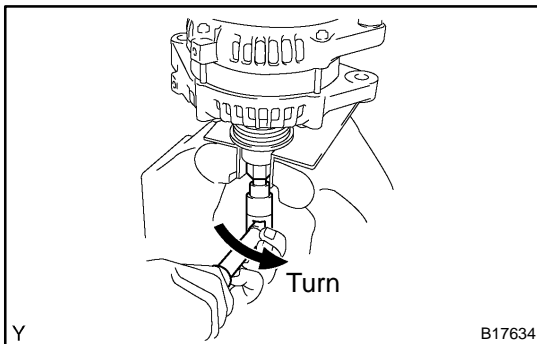

- (d) To loosen the pulley nut, turn SST (A) in the direction shown in the illustration.

#### NOTICE:

**To prevent damage to the rotor shaft, do not loosen the pulley nut more than one-half turn.**

- (e) Remove the generator from SST (C).

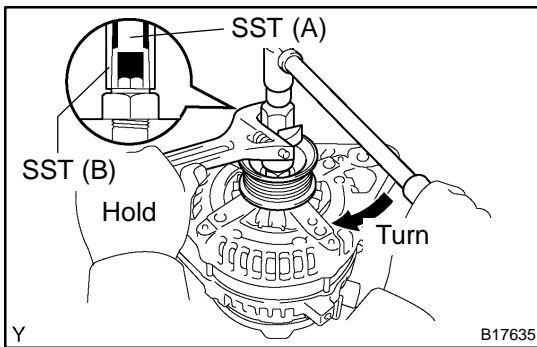

- (f) Turn SST (B), and remove SST (A) and (B).

- (g) Remove the pulley nut and pulley.

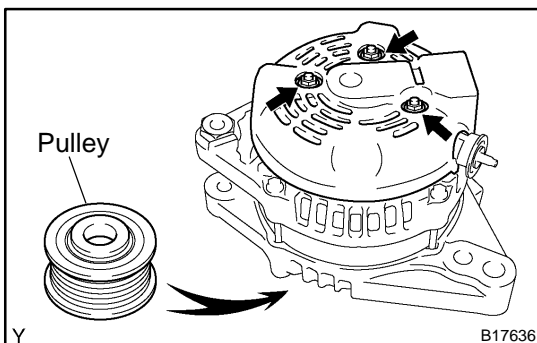

### 2. REMOVE GENERATOR REAR END COVER

- (a) Place the generator on the pulley.

- (b) Remove the 3 nuts and rear end cover.

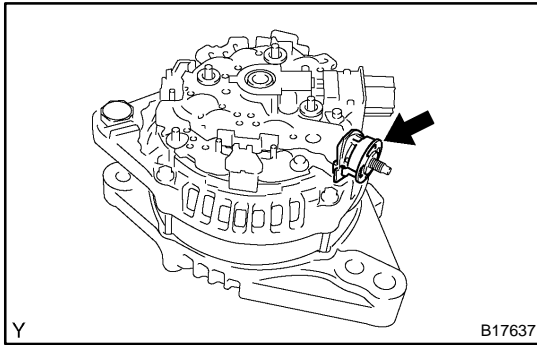

### 3. REMOVE TERMINAL INSULATOR

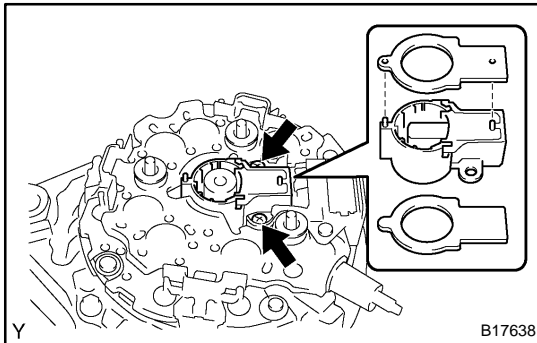

### 4. REMOVE GENERATOR BRUSH HOLDER ASSY

- (a) Remove the plate seal.
- (b) Remove the 2 nuts and brush holder.
- (c) Remove the plate seal.

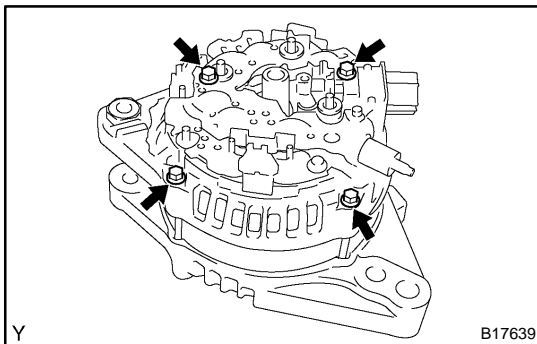

### 5. REMOVE GENERATOR COIL ASSY

- (a) Remove the 4 bolts.

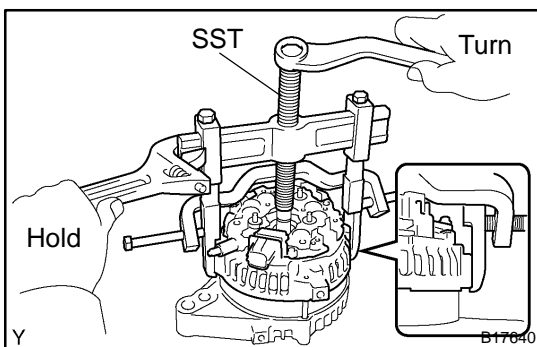

- (b) Using SST, remove the coil.

SST 09950-40011 (09951-04020, 09952-04010, 09953-04020, 09954-04010, 09955-04071, 09957-04010, 09958-04011)

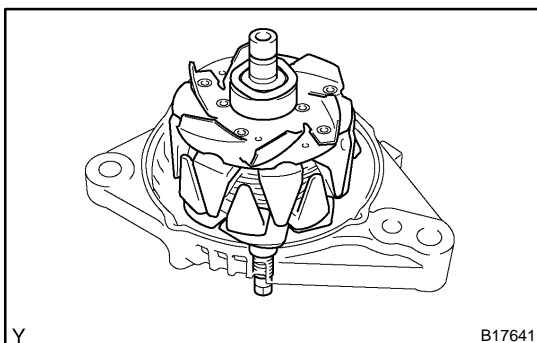

### 6. REMOVE GENERATOR ROTOR ASSY

- (a) Remove the washer and rotor.